



## Historic Preservation Services

Community Development & Neighborhood Services

281 North College Avenue

P.O. Box 580

Fort Collins, CO 80522.0580

970.416.4250

[preservation@fcgov.com](mailto:preservation@fcgov.com)

[fcgov.com/historicpreservation](http://fcgov.com/historicpreservation)

### CERTIFICATE OF APPROPRIATENESS

**ISSUED: July 13, 2021**

**EXPIRATION: July 13, 2022**

Nicole & Matthew Ross  
1006 Laporte Avenue  
Fort Collins, CO 80521

Dear Property Owner:

This letter provides you with confirmation that the proposed changes to your designated Fort Collins landmark property, the Marsh-Geist House & Garage at 1006 Laporte Avenue have been approved by the City's Historic Preservation Division because the proposed work meets the criteria and standards in Chapter 14, [Article IV](#) of the Fort Collins Municipal Code.

- 1) Demolition of non-historic front porch stairs
- 2) Construction of new concrete stair with a concrete cap based on historic images, with addition of metal railings to meet code requirements.

Notice of the approved application has been provided to building and zoning staff to facilitate the processing of any permits that are needed for the work.

Please note that all ensuing work must conform to the approved plans. Any non-conforming alterations are subject to stop-work orders, denial of Certificate of Occupancy, and restoration requirements and penalties.

If the approved work is not completed prior to the expiration date noted above, you may apply for an extension by contacting staff at least 30 days prior to expiration. Extensions may be granted for up to 12 additional months, based on a satisfactory staff review of the extension request.

Property owners can appeal staff design review decisions by filing a written notice of appeal to the Director of Community Development & Neighborhood Services within fourteen (14) days of this decision. If you have any questions regarding this approval, or if I may be of any assistance, please do not hesitate to contact me. I may be reached at [jbertolini@fcgov.com](mailto:jbertolini@fcgov.com), or 970-416-4250.

Sincerely,

Jim Bertolini  
Historic Preservation Planner

Applicable Code Standard	Summary of Code Requirement and Analysis (Rehabilitation)	Standard Met (Y/N)
SOI #1	<p><i>A property will be used as it was historically or be given a new use that requires minimal change to its distinctive materials, features, spaces, and spatial relationships;</i></p> <p><b>The property is retaining its residential use.</b></p>	Y
SOI #2	<p><i>The historic character of a property will be retained and preserved. The removal of distinctive materials or alteration of features, spaces, and spatial relationships that characterize a property will be avoided.</i></p> <p><b>The new stairs will rehabilitate an historic element, with added railings to meet modern code compliance requirements.</b></p>	Y
SOI #3	<p><i>Each property will be recognized as a physical record of its time, place, and use. Changes that create a false sense of historical development, such as adding conjectural features or elements from other historic properties, will not be undertaken.</i></p> <p><b>The wood stairs were installed at some point in the 1980s-1990s and are not historic. It is appropriate to restore the historic stair configuration.</b></p>	Y
SOI #4	<p><i>Changes to a property that have acquired historic significance in their own right will be retained and preserved.</i></p>	N/A
SOI #5	<p><i>Distinctive materials, features, finishes, and construction techniques or examples of craftsmanship that characterize a property will be preserved.</i></p>	N/A
SOI #6	<p><i>Deteriorated historic features will be repaired rather than replaced. Where the severity of deterioration requires replacement of a distinctive feature, the new feature will match the old in design, color, texture, and, where possible, materials. Replacement of missing features will be substantiated by documentary and physical evidence.</i></p> <p><b>With the exception of the metal railing, required for IEBC code compliance, the new concrete stair has been based on historic photographs of the property from the mid-twentieth century. This treatment meets this Standard.</b></p>	Y
SOI #7	<p><i>Chemical or physical treatments, if appropriate, will be undertaken using the gentlest means possible. Treatments that cause damage to historic materials will not be used.</i></p>	N/A
SOI #8	<p><i>Archeological resources will be protected and preserved in place. If such resources must be disturbed, mitigation measures will be undertaken.</i></p>	N/A

<b>SOI #9</b>	<i>New additions, exterior alterations, or related new construction shall not destroy historic materials that characterize the property. The new work shall be differentiated from the old and shall be compatible with the massing, size, scale, and architectural features to protect the historic integrity of the property and its environment.</i>	<b>N/A</b>
<b>SOI #10</b>	<i>New additions and adjacent or related new construction will be undertaken in such a manner that, if removed in the future, the essential form and integrity of the historic property and its environment would be unimpaired.</i>	<b>N/A</b>



# Design Review Application Historic Preservation Division

Fill this form out for all applications regarding designated historic buildings within the city limits of the City of Fort Collins. Review is required for these properties under Chapter 14, [Article IV](#) of the Fort Collins Municipal Code.

## Applicant Information

Applicant's Name	Daytime Phone	Evening Phone
Mailing Address (for receiving application-related correspondence)	State	Zip Code
Email		

## Property Information (put N/A if owner is applicant)

Owner's Name	Daytime Phone	Evening Phone
Mailing Address (for receiving application-related correspondence)	State	Zip Code
Email		

## Project Description

Provide an overview of your project. Summarize work elements, schedule of completion, and other information as necessary to explain your project.

### The following attachments are REQUIRED:

- Complete Application for Design Review
- Detailed Scope of Work (and project plans, if available)
- Color photos of existing conditions

### Reminders:

Complete application would need all of checklist items as well as both pages of this document.

Detailed scope of work should include measurements of existing and proposed.

*Please note: if the proposal includes partial or full demolition of an existing building or structure, a separate demolition application will need to be approved.*

*Additional documentation may be required to adequately depict the project, such as plans, elevations, window study, or mortar analysis. If there is insufficient documentation on the property, the applicant may be required to submit an intensive-level survey form (at the applicant's expense).*

**Detail of Proposed Rehabilitation Work (\*Required)**

If your project includes multiple features (e.g. roof repair and foundation repair), you must describe each feature separately and provide photographs and other information on each feature.

<b>Feature A Name:</b>	
Describe property feature and its condition:	Describe proposed work on feature:
<b>Feature B Name:</b>	
Describe property feature and its condition:	Describe proposed work on feature:

Use Additional Worksheets as needed.

## Required Additional information

The following items must be submitted with this completed application. Digital submittals preferred for photographs, and for other items where possible.

- At least one current photo for each side of the house. Photo files or prints shall be named/labeled with applicant name and elevation. For example, smitheast.jpg, smithwest.jpg, etc. If submitted as prints, photos shall be labeled
- Photos for each feature as described in the section "Detail of Proposed Rehabilitation Work". Photo files or prints shall be named or labeled with applicant name and feature letter. For example, smitha1.jpg, smitha2.jpg, smithb.jpg, smithc.jpg, etc.

Depending on the nature of the project, one or more of the following items shall be submitted. Your contractor should provide these items to you for attachment to this loan application.

- Drawing with dimensions.
- Product specification sheet(s).
- Description of materials included in the proposed work.
- Color sample(s) or chip(s) of all proposed paint colors.

**Partial or full demolition** is a part of this project.

Partial demolition could include scopes such as taking off existing rear porches to create space for a new addition or removing an existing wall or demolishing a roof. If you are taking away pieces of the existing residence, you are likely undergoing some partial demolition.

\_\_\_\_\_  
Signature of Applicant

\_\_\_\_\_  
Date



1006 W LA PORTE

MATT ROSS

PORCH STAIRS

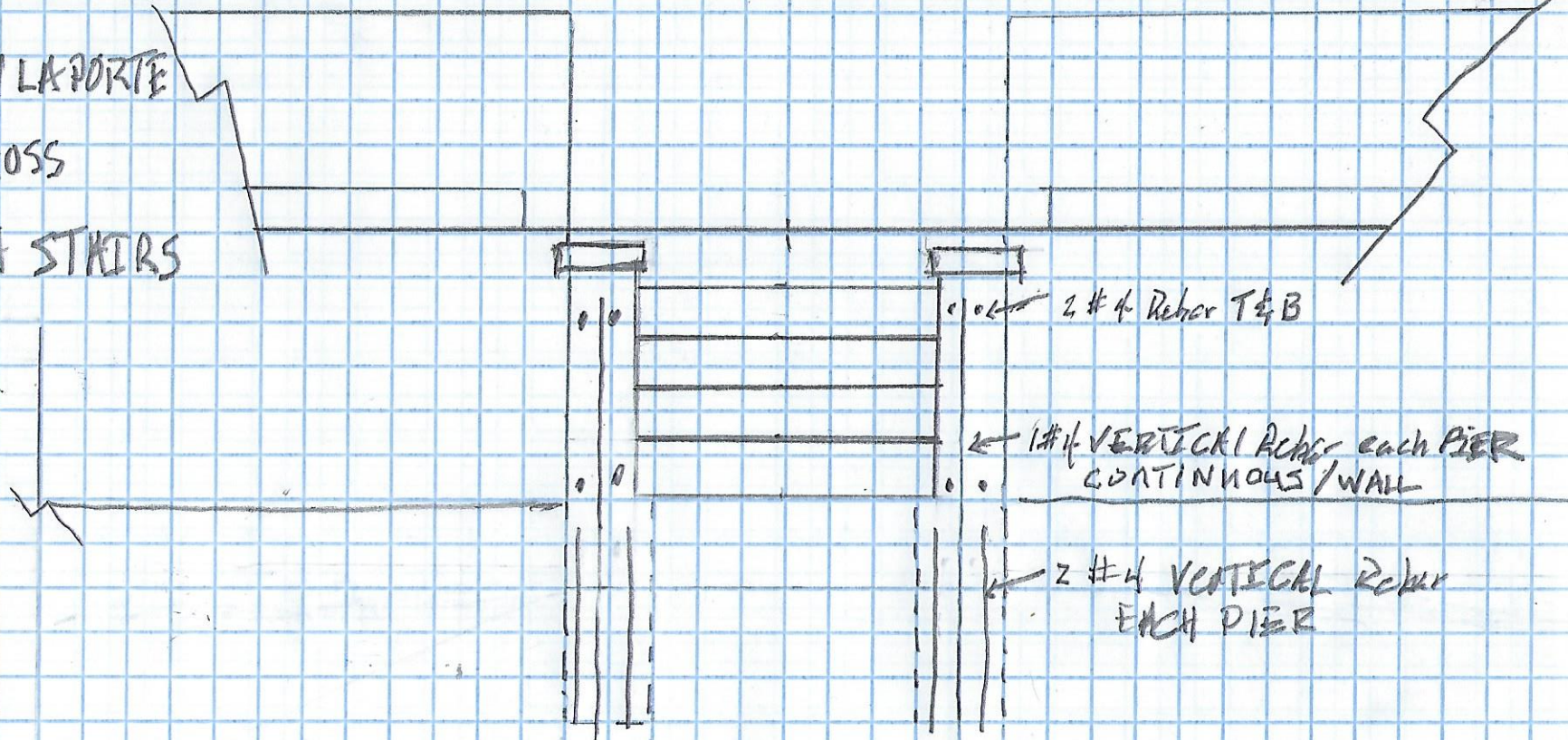

NOT TO SCALE

EXISTING PORCH

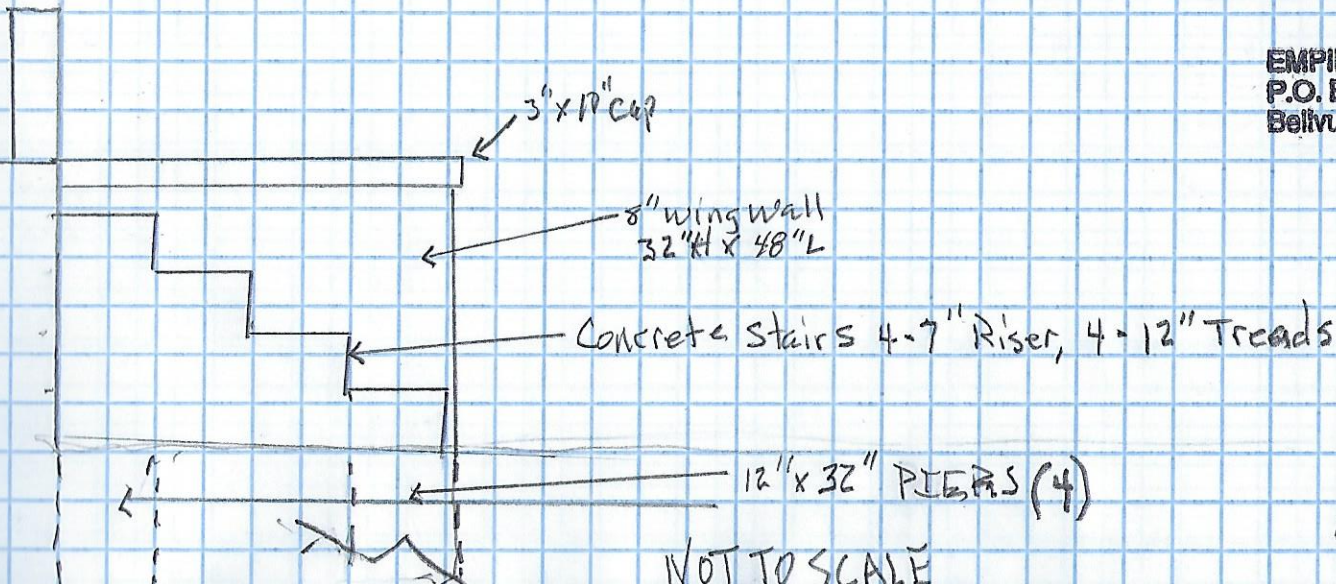

NOT TO SCALE

EMPIRE CARPENTRY  
P.O. Box 245  
Bellvue, Colo. 80512

6/9/21 TS

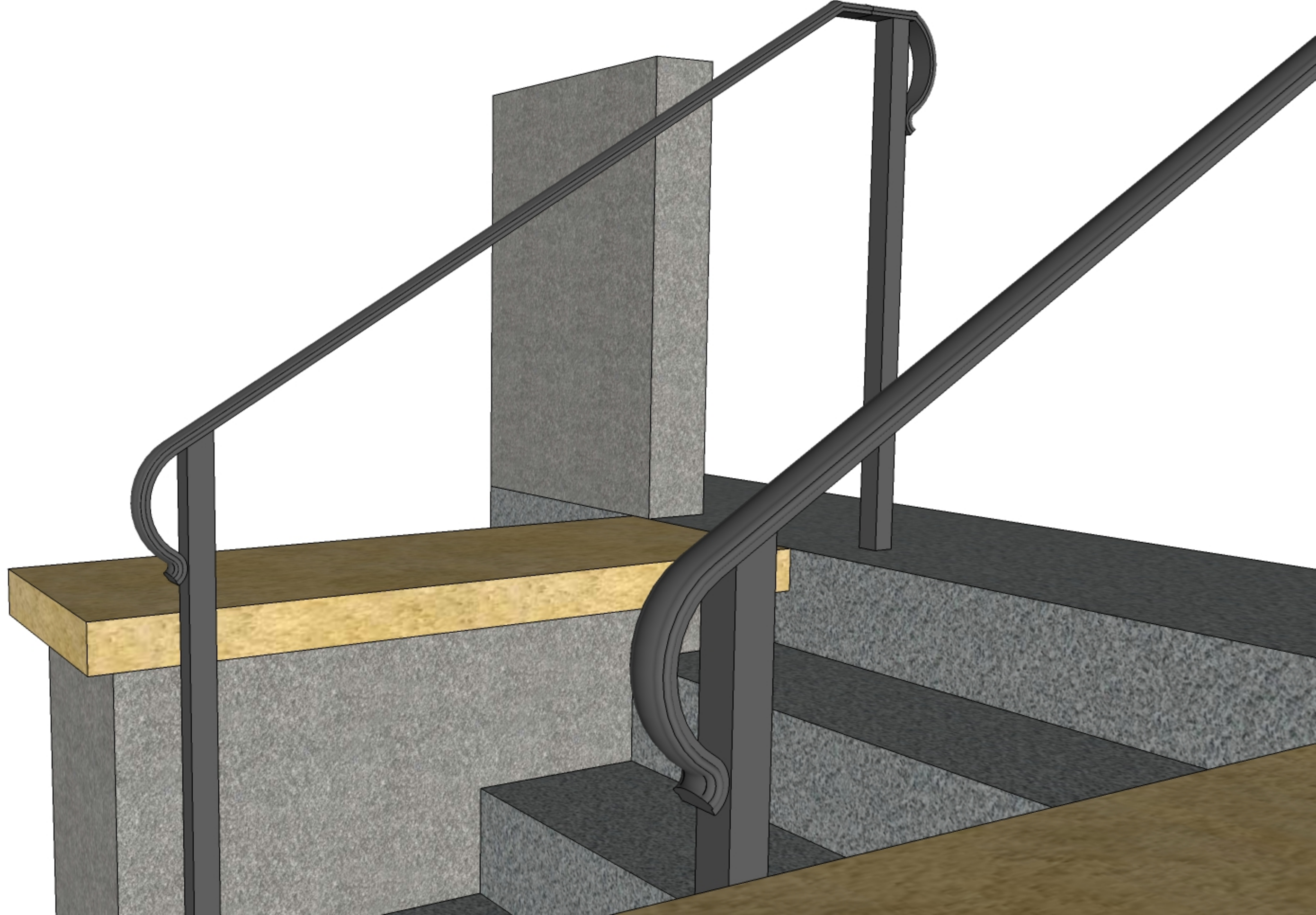



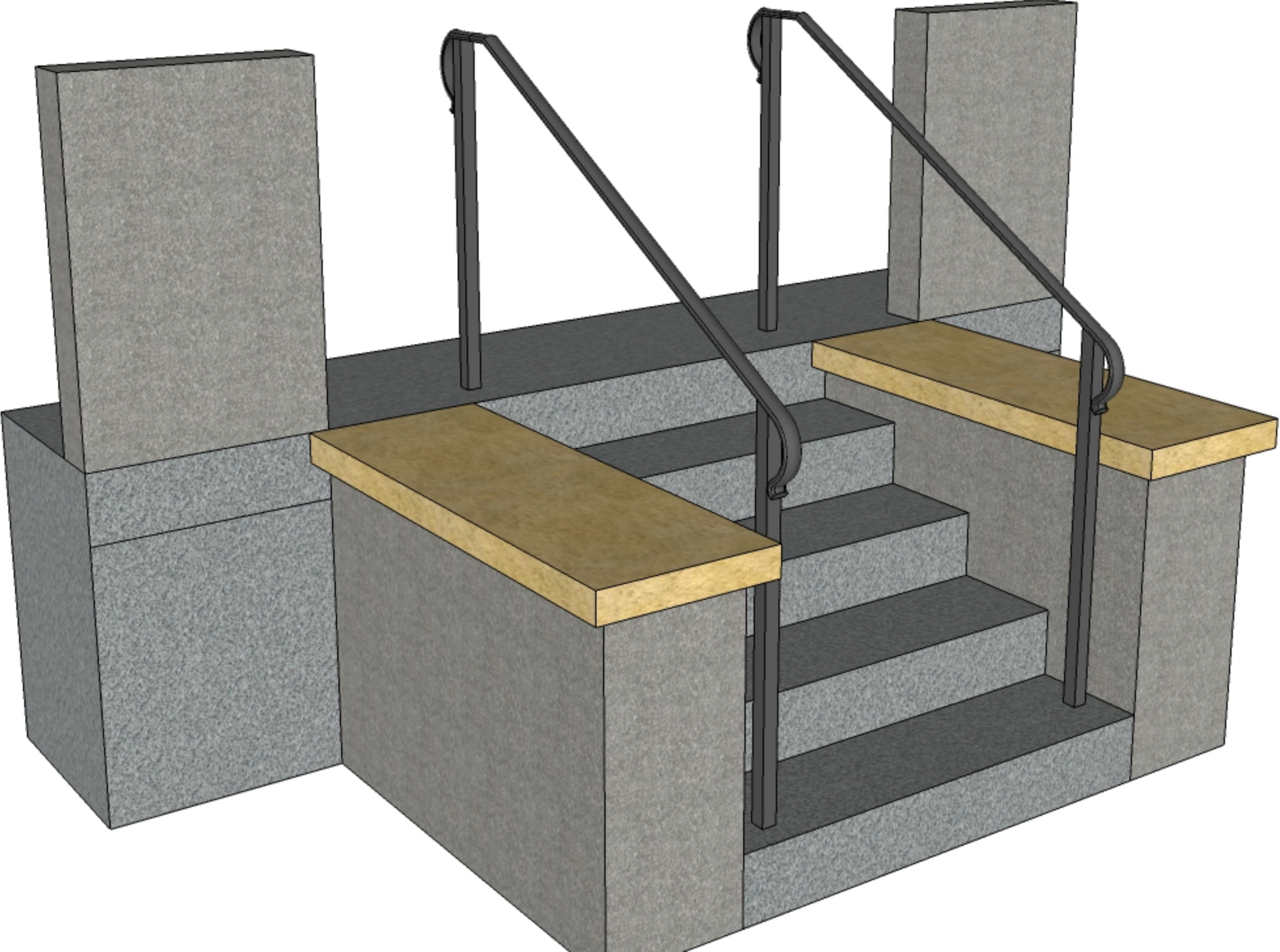

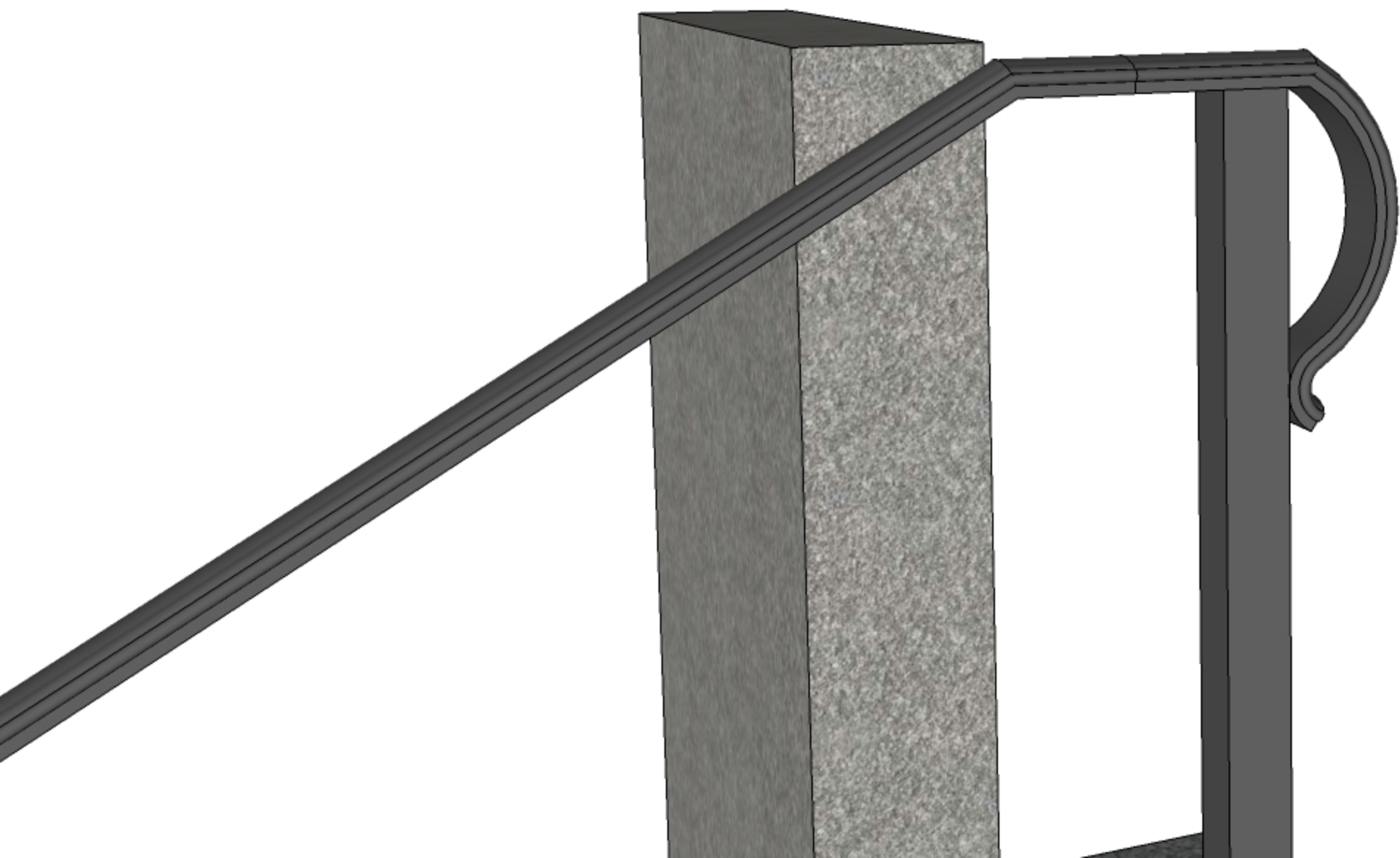









4 Treads  
5 Risers

STONE →  
CAPS

66"

35"